

Note: Verify parapet heights & wind uplift requirements.

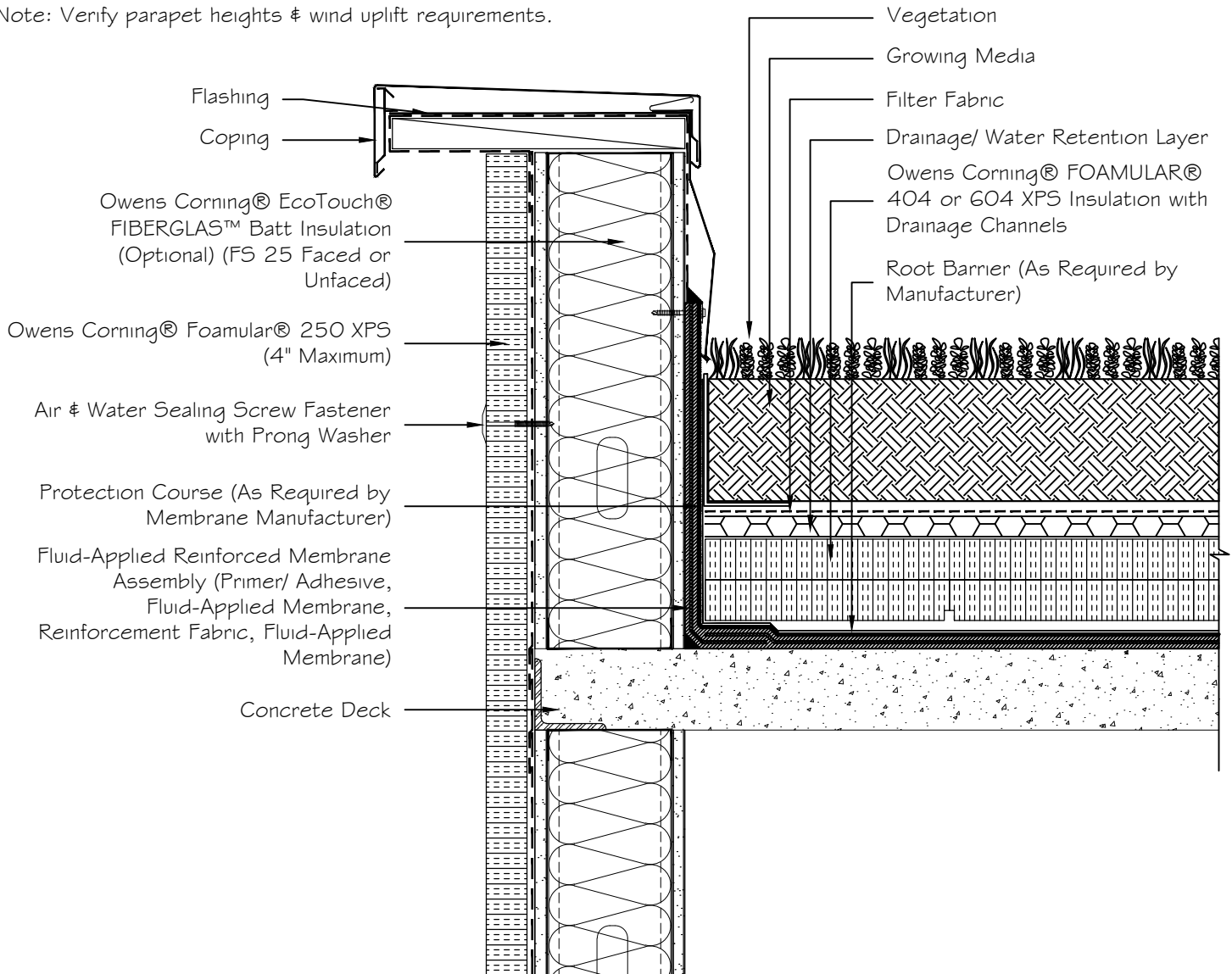

**Owens Corning**  
**Enclosure Solutions**  
 PRMA Roof System

VRA Roof Parapet Transition

Date: 3-2-17

Dwg. no. ES-PRMA-FA-21

Horizontal Section

NOTE: This drawing is a general reference intended to show common roof system assemblies. Actual details for each product will vary, therefore, details for each project must be reviewed and approved by the Architect of Record. Refer to Manufacturers' Product Literature for product data and installation instructions. Manufacturers assume no responsibility for final project drawings or field installation.