

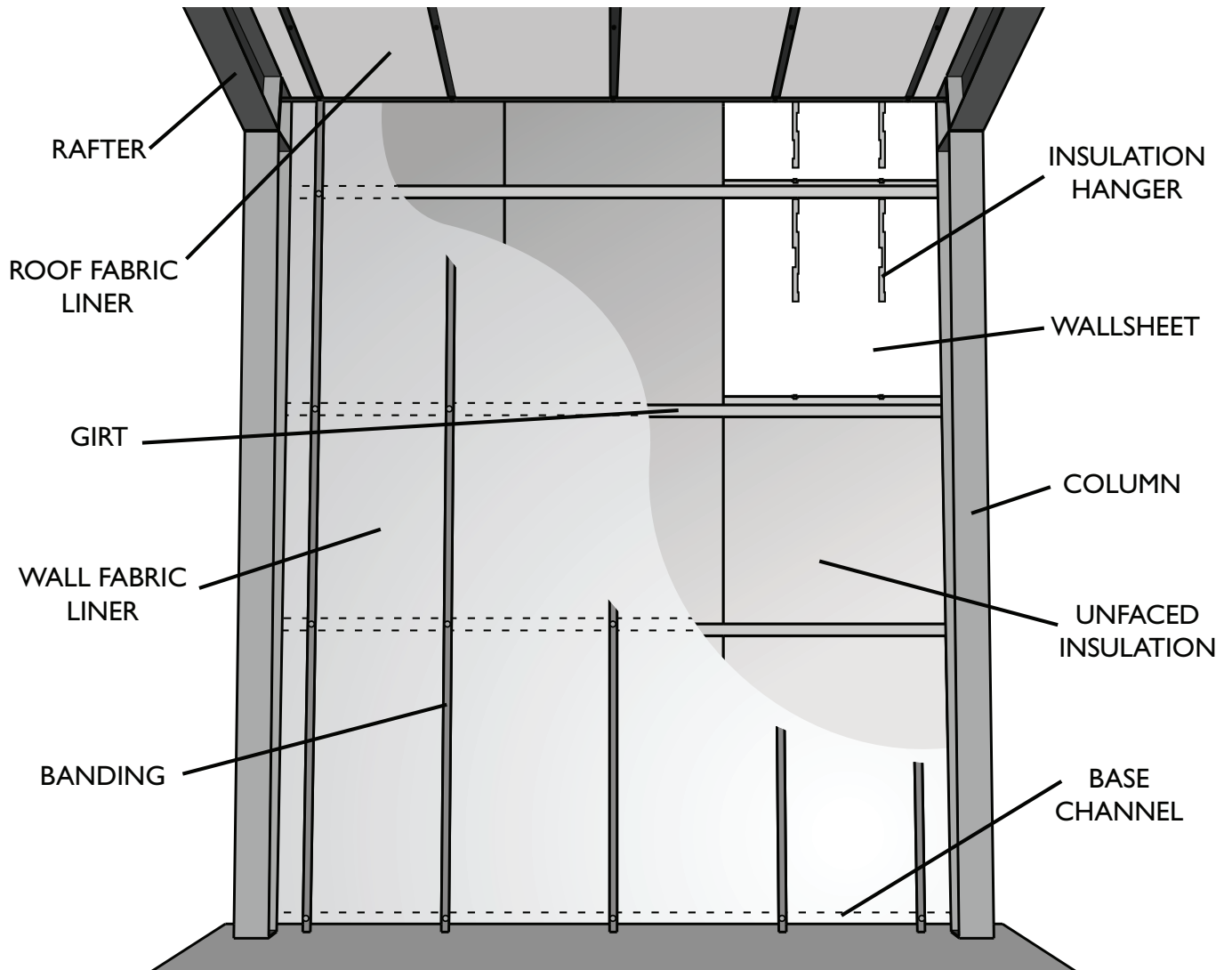

INNOVATIONS FOR LIVING®

OptiLiner™ Banded Liner System

Wall Installation Instructions



General

Introduction

The OptiLiner™ Banded Liner System is designed to provide maximum thermal performance in pre-engineered metal buildings using Owens Corning™ metal building insulation. In addition to excellent thermal performance, this system offers superior acoustics, finished appearance and a brighter interior.

Safety Considerations

This system shall be installed by a contractor employing a site specific safety plan.

Before You Start

- Open pallets and packaging to ensure complete order was received
- Review drawings to ensure each custom made fabric panel is installed in the appropriate area
- Obtain necessary base channel for your building type
- Assemble appropriate equipment and tools
- Assure weather is appropriate to begin installation



INNOVATIONS FOR LIVING®

OptiLiner™ Banded Liner System

Wall Installation Instructions

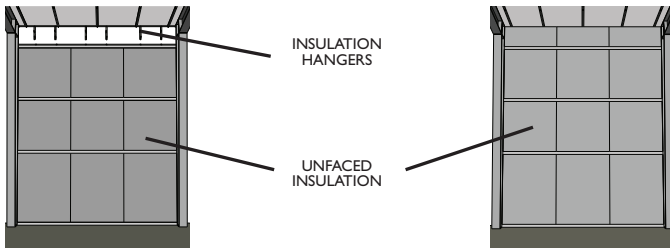

Banding and Fabric

1. Determine the number of vertical bands spaced the same as the roof bands and cut each to the proper length.
2. At this time, cut and install the longitudinal roof band at both ends to the bottom of the rafter (tight to back corner of rafter) and parallel to the eave strut flush with the inside flange of the wall girts.

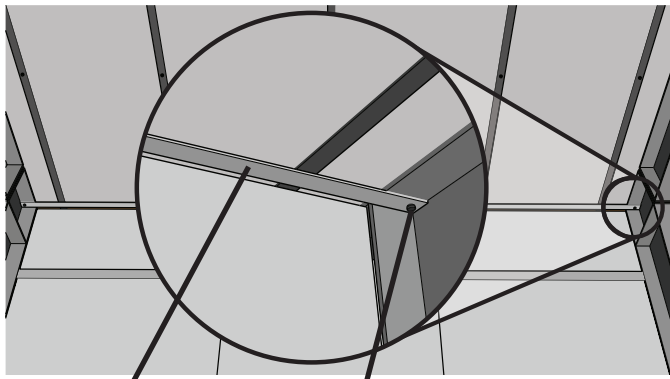

LONGITUDINAL ROOF BAND FASTENER

3. Locate the appropriately sized fabric for the bay in which you are installing.
4. Unroll the fabric at the base channel of the wall and lift the fabric into position.
5. At one corner of the fabric and at the rafter & roof intersection, begin positioning the fabric against the inside of the column, three inches over the longitudinal roof band.
6. Clamp in place at the roof bands to hold in several points across the top of the entire wall area, positioning and squaring the fabric in the wall area (see image top of next column).

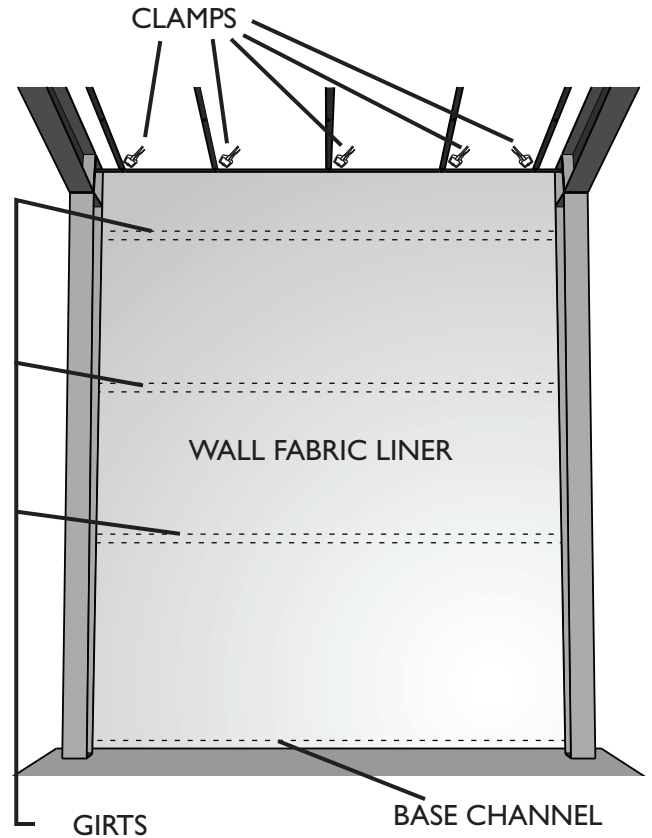

7. Adhere the wall fabric to the ceiling fabric with adhesive or double stick tape.
8. Install the wall bands by attaching a fastener through the wall band, the fabric and the longitudinal roof band across the eave.

