



ASLAN™ 700

NU-TIE™ SANDWICH WALL CONNECTOR

ASLAN™ 700 NU-TIE™ SHEAR CONNECTOR

HB Part Number	Insulation Thickness	Color Code	Unit Weight lbs (kg)
RNU3-2I6H-45	2" (50mm)	Green	0.40 (0.18kg)
RNU3-3I7H-44	3" (75mm)	Red	0.45 (0.20kg)
RNU3-4I8H-44	4" (100Mm)	Yellow	0.50 (0.23kg)

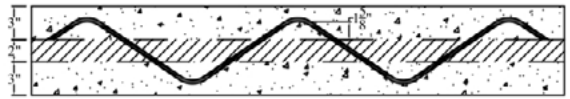
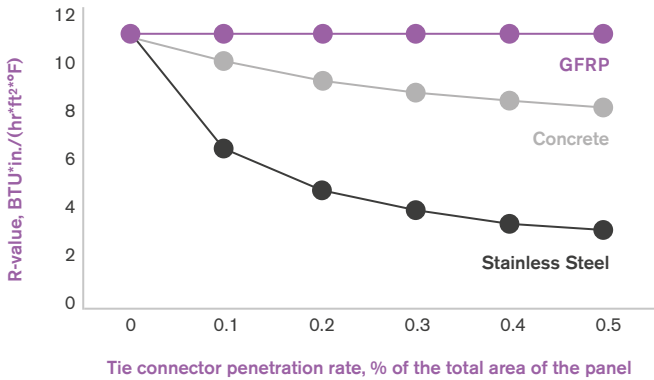

3'-2"-3" Wall

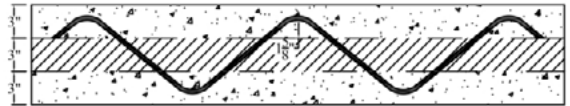

3'-3"-3" Wall

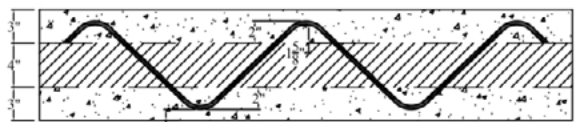

Cover 3'-4"-3" Wall

Material	Conductivity BTU in / (hr ft² °F)
Concrete	13.3
Foam Insulation	0.2
Metal Tie	314.4
Nu-Tie™ connectors	0.2

SPECIFYING NU-TIE™

> **Materials**

Insulated Sandwich Panel Connectors shall be thermally non-conductive, non-corrosive, fiber composite connectors with a minimum tensile strength of 110,000 psi when test per ASTM D7205 (straight portion). The connector must transfer horizontal shear between the inner and outer concrete layers to allow structurally composite wall panel behavior:

- > Aslan™ 700 Nu-Tie™ Sandwich Wall Connector
- > Approved Equal

> Insulation

Preferably, the sandwich panel insulation shall be: Extruded polystyrene with square corners complying with ASTM C-578, Type IV with the following properties:

- > Minimum thickness: inches (cm)
- > "R" Value: 5 per inch (minimum) at 75F mean Temperature
- > Density: 1.6 pcf minimum
- > Compressive Strength: 25 psi minimum at yield of 10 percent deformation per ASTM D1621
- > Water Absorption: 0.1 percent maximum per ASTM C272

> Insulated Precast Wall Panels

Type: Plant fabricate, precast, insulated wall panel consisting of a reinforced exterior wythe, insulation, and reinforced interior wythe.:

- > THiN-Wall™ by Composite Insulated Concrete Systems
- > GR-8 Wall by Concrete Industries, Inc
- > KEEP Panel by Kerkstra Precast
- > Approved Equal

Connect wythes together with non-conductive, non-corrosive, fiber composite sandwich panel connectors (see Materials). Wall panel thickness must be as shown on plans. Finish uniformed surface as indicated for each type of unit. Panel design shall take into consideration transportation and erection stresses. Include cast-in weld plates and inserts where required. Coordinate with other trades for installation of blockouts 144 in² (929cm²) and larger.

AMERICAS

Owens Corning
Composite Materials, LLC.
One Owens Corning Parkway
Toledo, OH 43659
1-800-GET-PINK™

EUROPE

European Owens Corning Fiberglas Sprl.
166 Chaussée de la Hulpe
B-1170 Brussels
Belgium
+32 2 674 8211

ASIA PACIFIC

Owens Corning Composite Solutions Business – Asia
Pacific Regional Headquarters
40/F, Pudong Kerry Parkside,
1155 Fang Dian Road, Pudong,
Shanghai, 201204, China
+86-21-6101 9666

This information and data contained herein is offered solely as a guide in the selection of product. We believe this information to be reliable, but do not guarantee its applicability to the user's process or assume any responsibility or liability arising out of its use or performance. The user agrees to be responsible for thoroughly testing any application of the product to determine its suitability. Because of numerous factors affecting results, we make no warranty of any kind, express or implied, including those of merchantability and fitness for a particular purpose. Statements in this publication shall not be construed as representations or warranties or as inducements to infringe any patent or violate any law, safety code or insurance regulation. We reserve the right to modify this document without prior notice. © 2017 Owens Corning. All Rights Reserved. THiN-Wall is a trademark of Composite Insulated Concrete Systems, LLC

Pub. 10022300. Aslan 700 sandwich wall connector product sheet_ww_06-2017_Rev0_EN. June 2017

